

TYPE 1

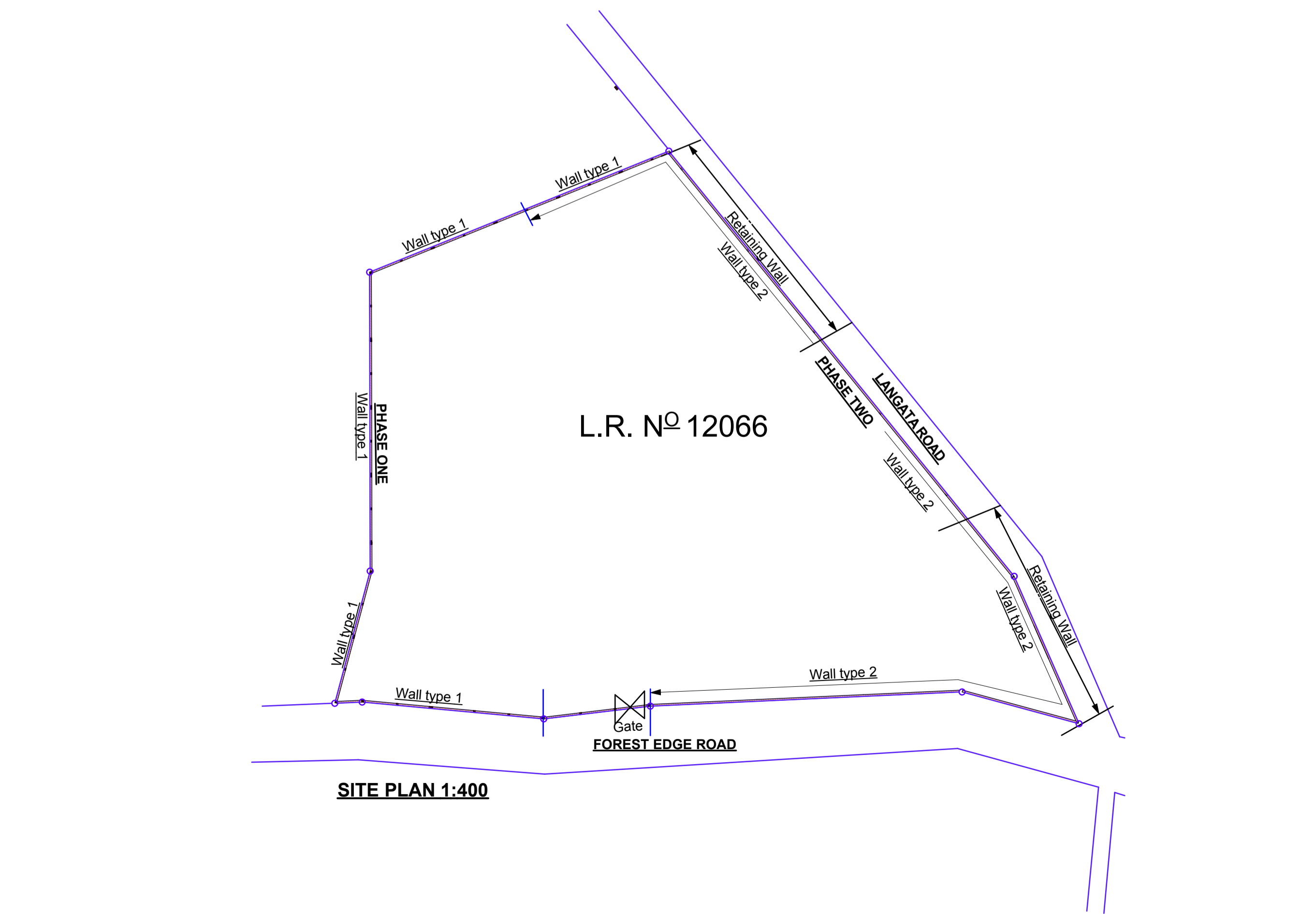

TYPE 2

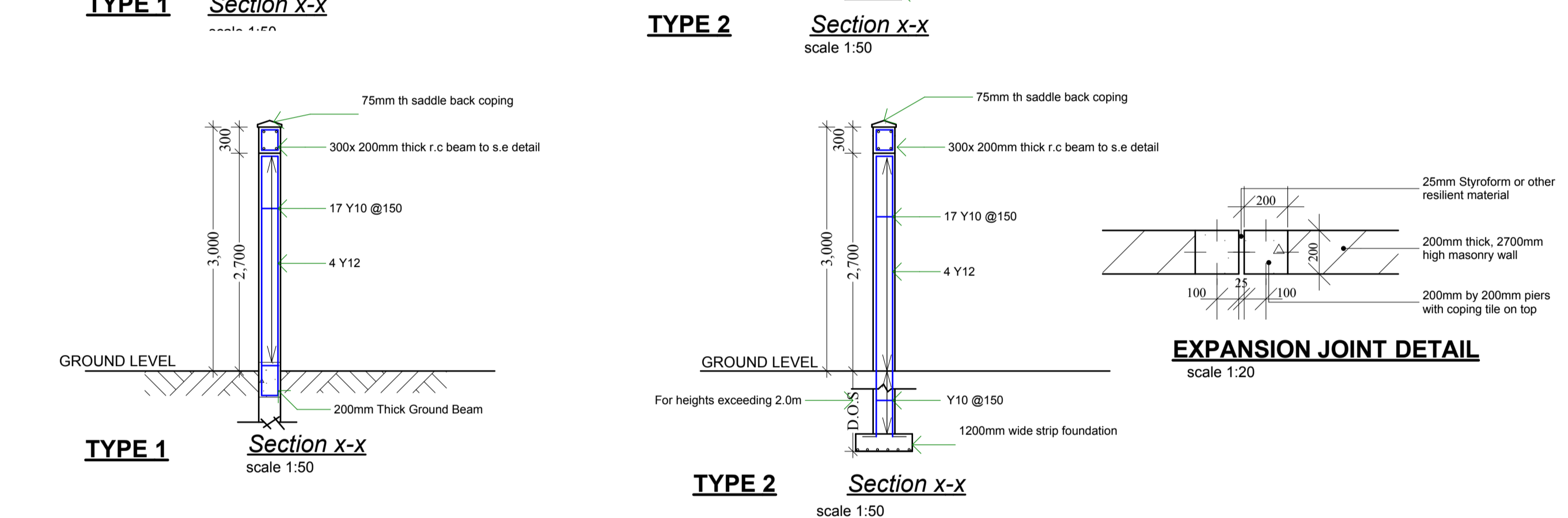
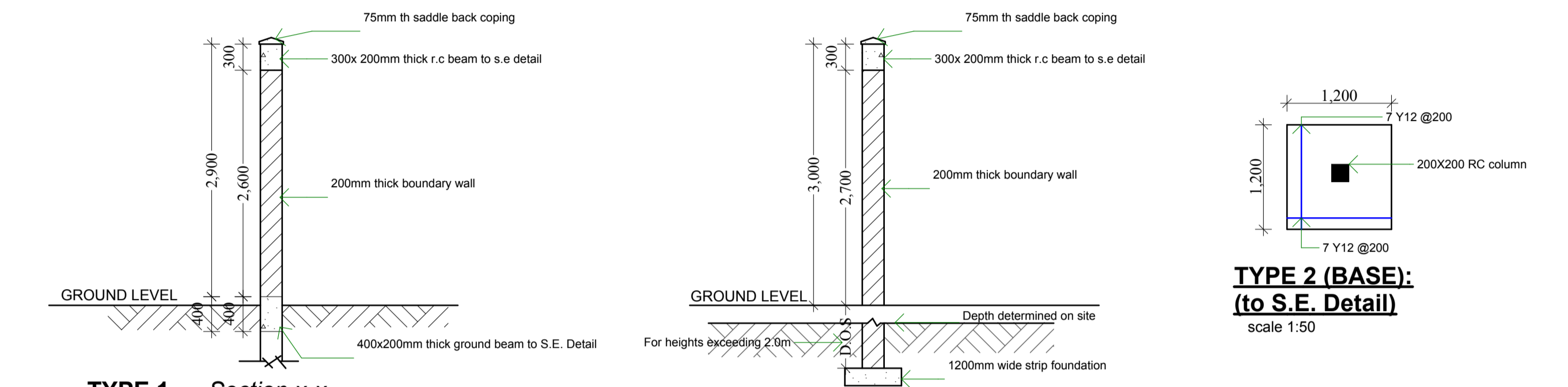
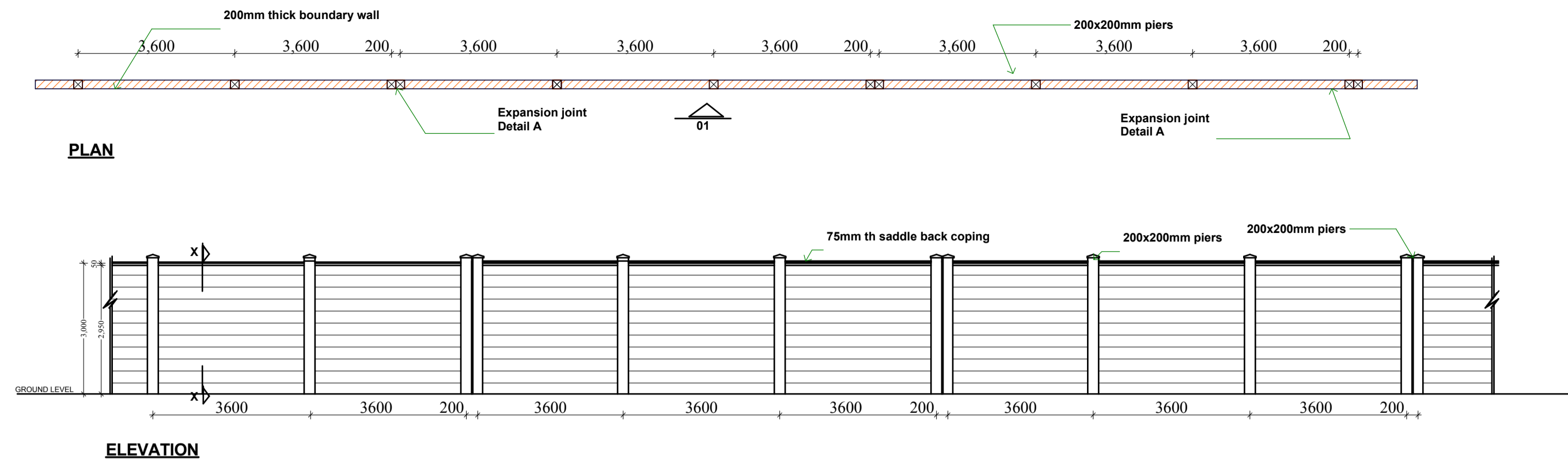
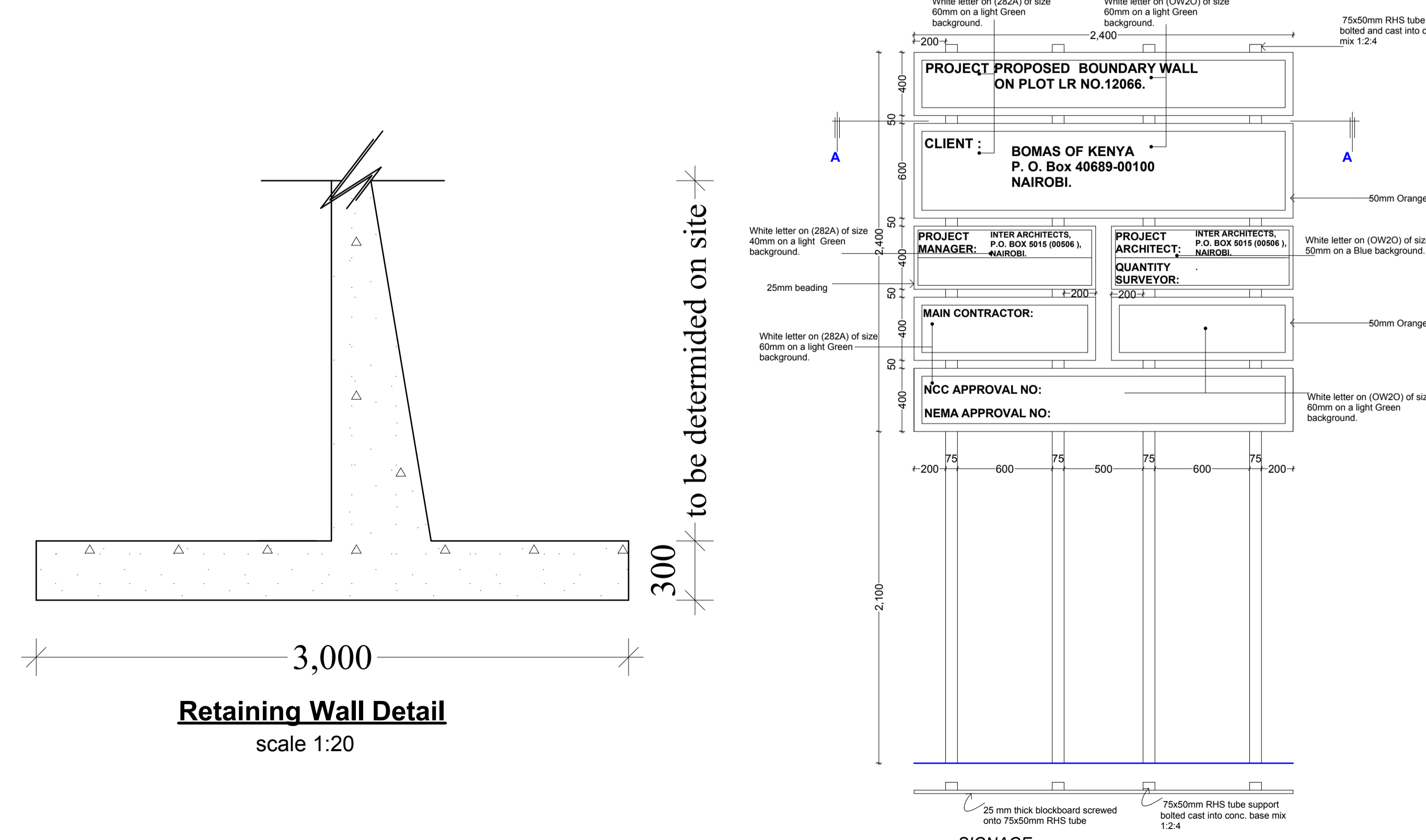
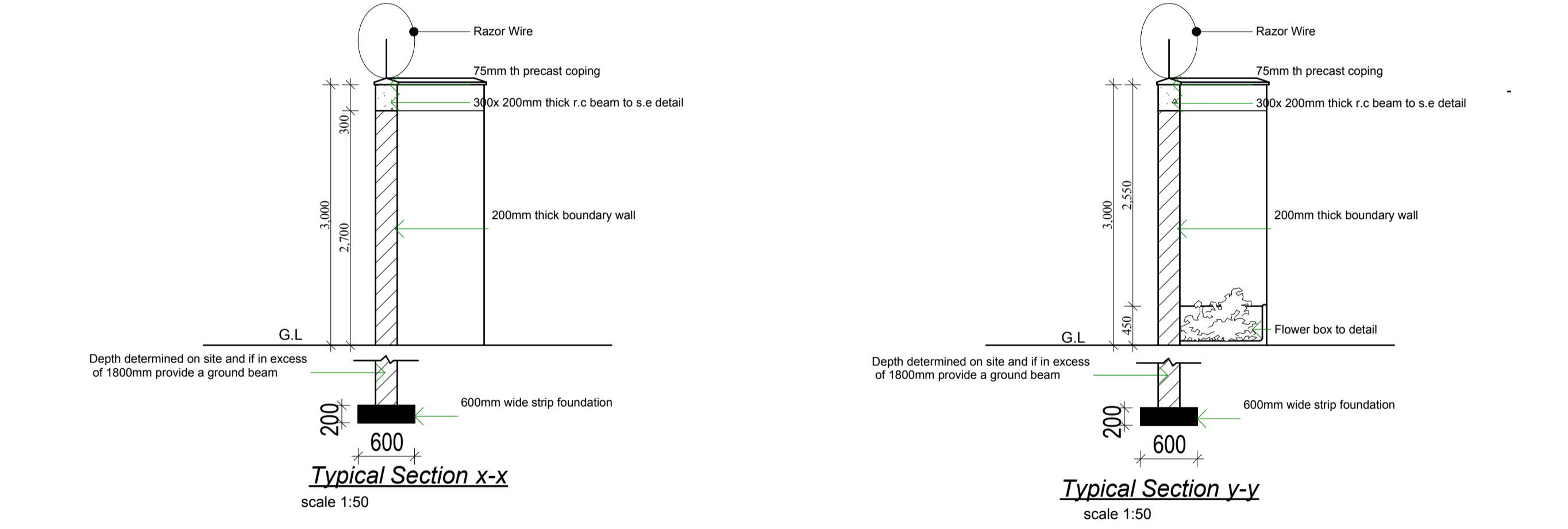
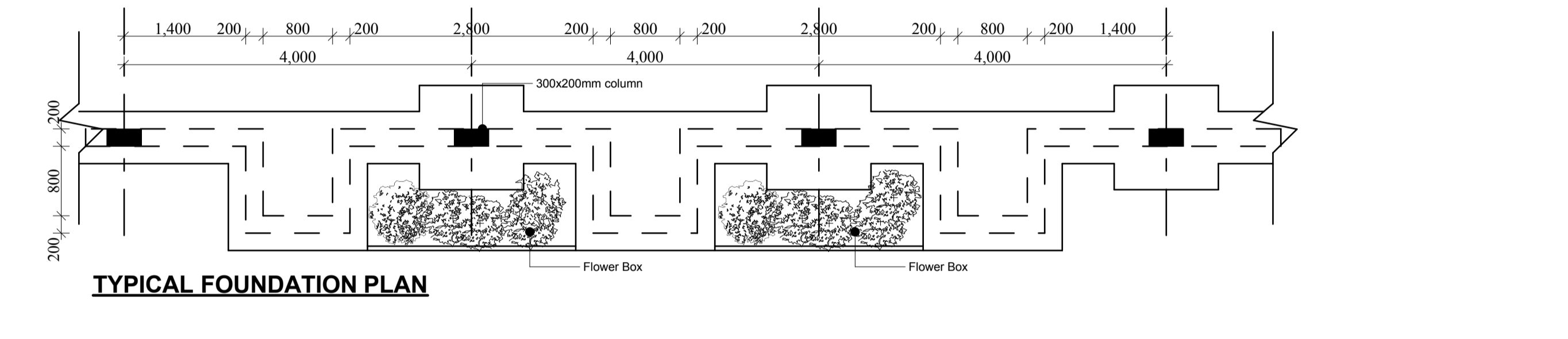
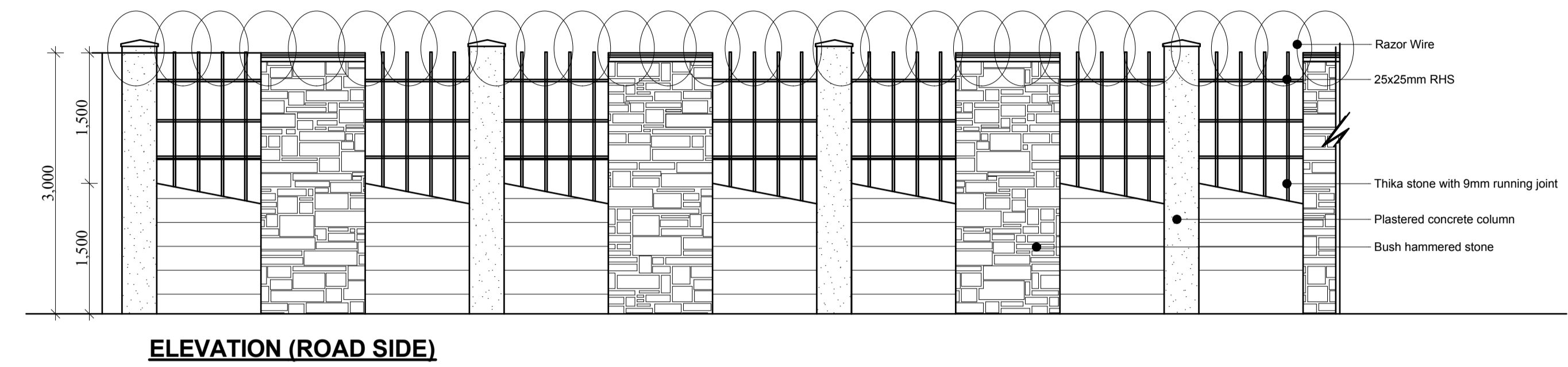
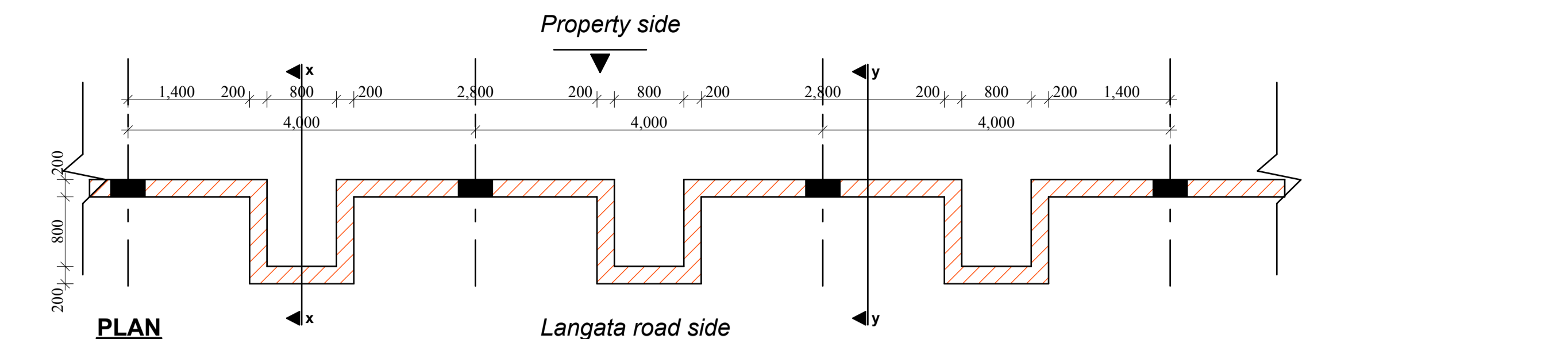

NOTES

General
All dimensions are shown in mm unless otherwise specified. Drawing are not to be scaled, only figured dimensions to be used. The contractor must check and verify all dimensions onsite before commencement on any work.

CONSTRUCTION
All slabs at ground level to be poured over 1000gauge polythene sheeting on 50mm thick stone dust on hardcore. All soils under slabs and all around external foundation to be poisoned for termites.

CIVIL
All soils on cut cut embankments to be stabilised, and the slope not to exceed the natural angle repose.

STRUCTURAL
All black cotton soils to be removed from below all buildings and paved surfaces. Building to be clear of black cotton soils to distance of 500mm outside the edge of the surface. For all R.C works, refer to Structural Engineers details. Depth of the foundation to be determined on site to Structural Engineers approval. All walls less than 200mm thick to be reinforced with hoop irons at every alternate course. All adjacents R.C works and masonry walls to be tied with straps iron at every course.

MECHANICAL
All plumbing and drainage to comply with local authority specifications. All services ducts to be accessible from all floors s.v.p denotes soil vents pipes to be provided the end of the drainage. Drains passings beneath buildings and drive-ways to be encased in 150mm thick concrete around. All underground fouts and waste drain pipes shall be UPVC to comply ith BS5255. All inspections chambers covers and framing shall be cast iron to comply with BS497 TABLE 2 GRADE A. The storm drain pipes to comply with BS556 inimum slope in the drain pipes to be 1% no cases will be allowed in the slabfor pipes sleeves will be allowed with written approval of the S.E no cuttings of the concrete with out express approval of the Architects or S.E. All testing pipes must be completed before plastering. All mechanical work must be co-ordinated with electrical and any conflict must be claimed before works began. P.V denotes permanents ventilation.

MECHANICAL
All conduits must be laid before plastering.

REVISION NOTES

Client
BOMAS OF KENYA LIMITED
P. O. Box 40689-00100
NAIROBI.

Client Sign

Project
Proposed Boundary Wall on
on plot lr no.12066
(Bomas of Kenya phase two).

Architects
Inter Architects
P. O. BOX 5015 NYAYO STADIUM
00506 NAIROBI
TEL 892272 ,3547677. FAX 890672

Drawing Title
PLANS ELEVATIONS AND SECTIONS

Checked PMK	Date OCT. 2013	Sheet no 01
Drawn KINUTHIA	Job No 2013/	Scale 1:20, 1:50